

FORM NO 1.

Courses on the Creek

- 1 S 72° W 41 f<sup>s</sup>
  - 2 N 70 W 10 1/2 "
  - 3 S 20 W 13 1/2 "
  - 4 S 17 E 38 "
- 103 f<sup>s</sup> in all.

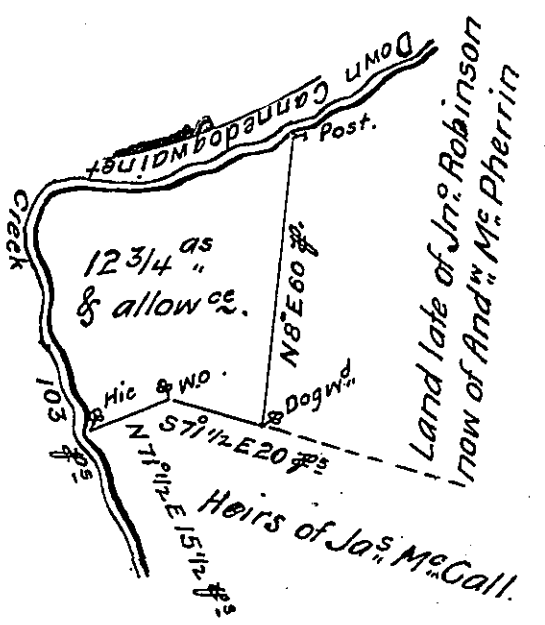

A Draft of a Piece of Land Situate in Lurgan Township in the County of Cum-  
 berland (now in the County of Franklin) Containing Twelve Acres and three qua-  
 rters of an Acre and an Allowance proportional to Six f<sup>s</sup>. Cent. for Roads &c.  
 Survey'd June 26<sup>th</sup> 1786 in pursuance of a Warrant granted to Hugh Wiley bearing  
 Date the 20<sup>th</sup> Day of February 1775.

Daniel Brodhead Esq. Matt<sup>y</sup>. Henderson D.S.

To ~~John Lukens Esq.~~  
 Surveyor General.

IN TESTIMONY that the above is a copy of the original remaining on file in  
 the Department of Internal Affairs of Pennsylvania, made  
 conformably to an Act of Assembly approved the 16th day of  
 February, 1833, I have hereunto set my Hand and caused  
 the Seal of said Department to be affixed at Harrisburg,  
 this fifth day of September 1907

*Henry Houck*  
 Secretary of Internal Affairs.